

**COOLCAM** 

**P60xG** 

User Manual

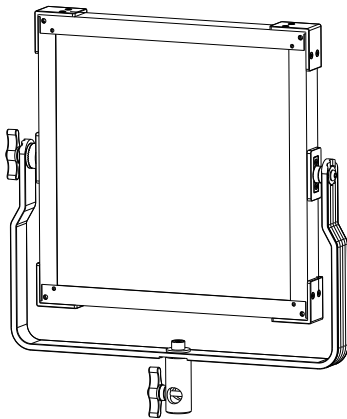

# 1.Introduction

Thank you for purchasing the Lishuai COOLCAM series of LED video lights. The LiShuai COOLCAM series products are the high-performance professional lights specially designed for high-end live streaming and commercial shooting.

The COOLCAM P60X [G] light body is compact and lightweight yet delivers exceptional performance with high brightness, excellent color rendering, and a high-quality light source, significantly enhancing picture quality. Moreover, it comes with the new Light Reel APP, which provides more options for live streaming rooms and studio lighting. With 0-100% precise stepless dimming, 11 built-in movie grade special effects, it offers functional settings that cater to different scenarios and comprehensively improve work efficiency. It also features single or dual color temperature selection, wireless light control methods, which makes it easy to unleash your creativity without pressure.

## 2. Warnings

1. Do not disassemble or modify the light.
2. Do not operate with wet hands, doing so may cause electric shock.
3. Do not operate in environments near flammable gasses or volatile liquids as this may increase the risk of explosion/fire.
4. Do not operate in enclosed spaces where heat buildup can be extreme, such as a car on a sunny day. The increased heat may cause premature failure of the lighting unit.
5. Do not touch the plug or AC adapter with wet hands; doing so may cause electric shock.
6. Do not damage, disassemble, pull or twist the power cord, otherwise it may cause fire or electric shock.
7. Do not place under heavy objects.
8. Keep the light surface clean with a soft, dry cloth.
9. Use ONLY the provided AC power adapter; using other AC power adapters may result in damage to the light.
10. Do not forcefully collide with the LCD touch screen to avoid damage.
11. Avoid dust and debris buildup on the light surface as this will change illuminance and color temperature.
12. When using accessories please ensure that these are installed properly to avoid damage to the light or other safety issues caused by falling accessories.
13. Please loosen the adjustment & locking handle before adjusting the angle of the lamp body.

### 3. Standard Equipment List

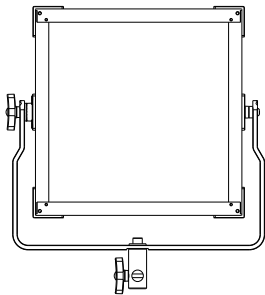

Light body  
(1pc)



Softbox  
(1pc)



Power adapter  
(1pc)

bracket  
(1pc)



Power cord  
(1pc)



Instruction manual  
(1pc)

## 4.Parts Diagram

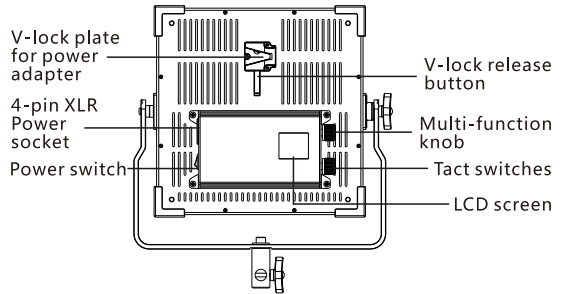
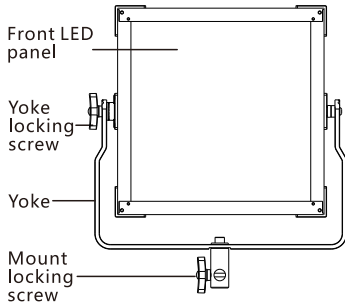

## 5.Operation Instructions

### 1.Light Installation

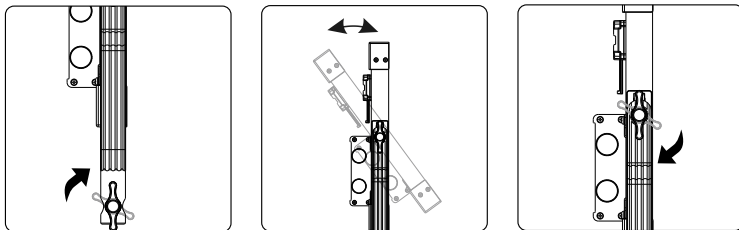

Tighten the stand mount locking screw to fix the light on the tripod, adjust the appropriate angle with the light handle, and then lock the locking handle clockwise.

### 2.Soft box installation(can be based on usage requirements)

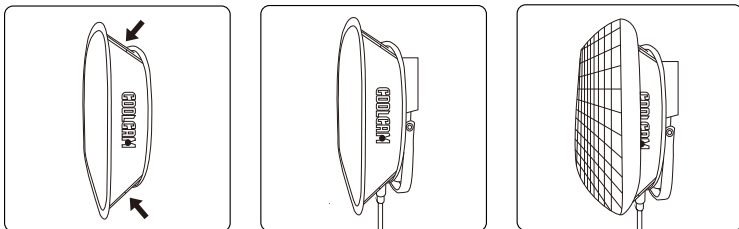

Open the soft box, straighten the support rods on the four sides of the soft box, and then install the soft box to the lamp and fix it. You can also install a grid according to your needs.

### 3.Adapter fixation

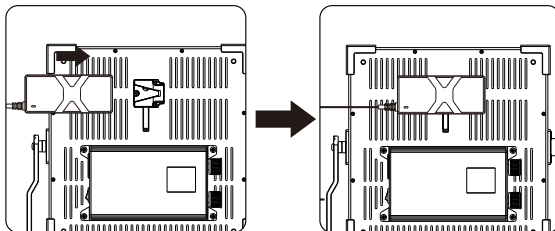

Align the V-shaped plastic part at the bottom of the adapter with the V-lock plate on the back of the light, and push it in from left to right. When you hear a click, it means it is fully buckled.

### 4.Power Supply

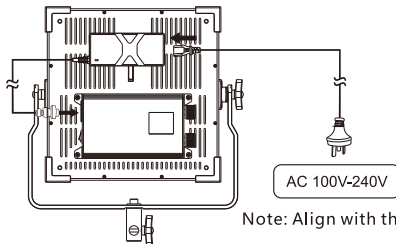

Connect the power adapter to the light fixture by inserting the power adapter plug into the DC power input socket in the lower left side of the light fixture. Connect the AC power cable to the external power supply (AC100-240V)

## 5. Power on and turn on the power switch

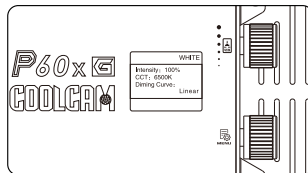
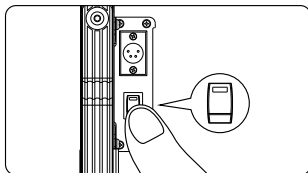

Turn on the power and turn on the power switch on the left side of the control box. The LCD screen of the control box will display a white light interface.

## 6. White Mode

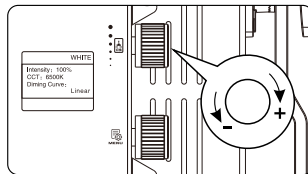
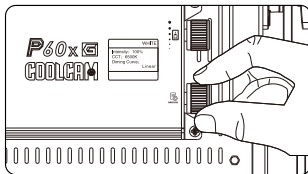

Rotate the menu knob to enter the white light interface, and short press the selector knob to switch between brightness, color temperature and dimming curve modes. Rotate the selector knob to adjust the value, with a brightness adjustment range of 0-100% and a color temperature adjustment range of 2700K-6500K. Rotate the selector knob to switch between linear, exponential, logarithmic, and S-Curve.



## 7.FX Mode

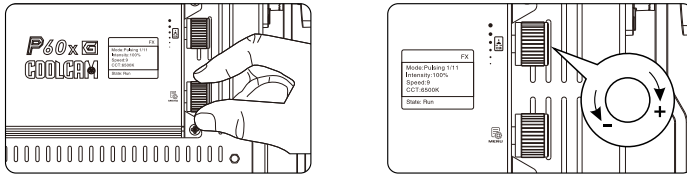

Rotate the menu knob to enter the special effects interface and short press the selector knob to switch between mode, brightness, speed, and color temperature. To adjust the settings, rotate the selector knob to the desired value. The special effects mode range is from 1 to 11. The brightness adjustment range can be set from 0 to 100%. Adjust the speed with the selector knob within the range of 0 to 9. You can also adjust the color temperature by selecting between 2700K to 6500K, or by selecting warm white, neutral, or cold white.

## 8.Remote Control Mode(remote control for optional purchase)

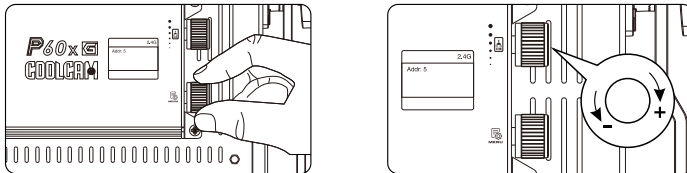

Rotate the menu knob to enter the remote control interface and rotate the selector knob to adjust the address. The remote control address adjustment range is 1-12, and the remote control address selection is synchronized with the light.

Noted: RMT-OFF means that the remote control function can not be used.

## 9. Setting Mode

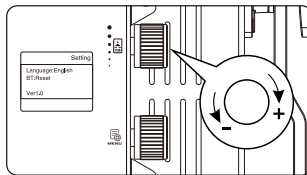
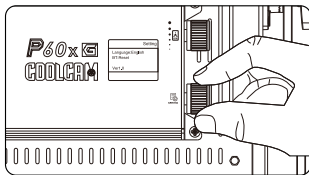

Rotate the menu knob to enter the settings interface and short press the selector knob to switch between language and Bluetooth settings.

a. Language switching: Rotate the selector knob to switch between Chinese and English options.

b. Bluetooth settings: Before using the APP to control the lighting, rotate the selector knob to reset the Bluetooth of the lighting.

## 10. APP Control



Operation Instruction



Download the APP

Users can search for "Light Reel" in the Apple store and Android market, or scan the QR code above to download APP to control the lighting.

## 11.Firmware Upgrade

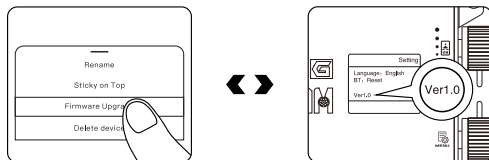

Users can upgrade their firmware through the Light Reel APP. After the upgrade is successful, they need to restart the lighting and enter the settings interface to view the current device version.

## 6.Product specifications

Product model	P60X 【G】
Power	60W
Beam angle	120°
Color temperature	2700K-6500K
CRI	≥95
TLCI	≥97
Rf	Average 94
Rg	Average 104
Working voltage/current	AC power adapter:AC100V-240V , Light fixture:DC15V
Size	360 x 380 x 60mm
Weight	2.2kg

<b>P60X [G] Illuminance data</b>						
CCT	Distance Data	1m	2m	3m	4m	5m
	<b>2700K</b>	W/O reflector	1753 lux	481 lux	235 lux	148 lux
W/Softbox		1157 lux	289 lux	141 lux	89 lux	62 lux
<b>3200K</b>	W/O reflector	1904 lux	517 lux	259 lux	162 lux	112 lux
	W/Softbox	1257 lux	310 lux	155 lux	97 lux	67 lux
<b>5600K</b>	W/O reflector	2063 lux	562 lux	282 lux	174 lux	121 lux
	W/Softbox	1362 lux	337 lux	169 lux	104 lux	73 lux
<b>6500K</b>	W/O reflector	1970 lux	543 lux	271 lux	170 lux	118 lux
	W/Softbox	1300 lux	326 lux	163 lux	102 lux	71 lux

**Product specifications are based on testing our laboratory samples. The product may vary slightly, however these variations will not affect normal use. The design and specifications are subject to change without notice.**



---

☎ 0574-62763333/62636368    📠 0574-62636398    ✉ [ls@lishuai.com.cn](mailto:ls@lishuai.com.cn)

📍 No.55 East Zhenxing Road, Yuyao City Zhejiang Province, China